

Tamper Pendant

Installation Guide

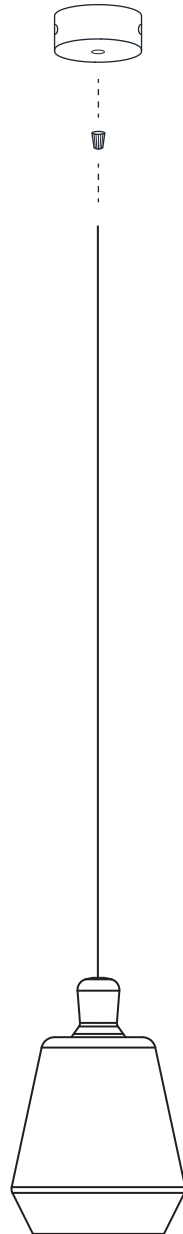

Instructions

All wall and ceiling fixtures are to be installed by a qualified electrician, do not attempt to install any products unless you are qualified to do so.

1. Unbox and check all components prior to assembly/installation.
2. Please refer to the Canopy Installation Instructions for further details.
3. Feed the flex through the cord grip to prepare the canopy for installation.
4. Please ensure the canopy is attached into a structural element in the ceiling that is certified for the weight of the pendant.
5. Fully install the canopy to the ceiling and fasten the flex at the preferred hanging height. Feed additional flex through the ceiling to allow for future height adjustments.
6. This light is supplied with 4W LED globe. If you are substituting the globe, please select a similar globe specification or order from Stephanie Ng Design.

Canopy Installation Instructions

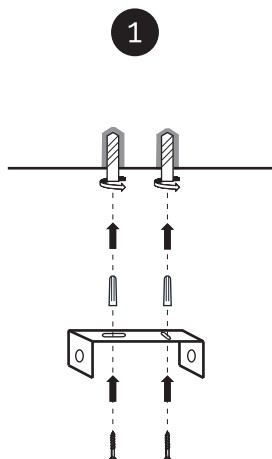

Prepare the ceiling to insert wall plugs.

Fix the bracket to the ceiling next to electrical mains.

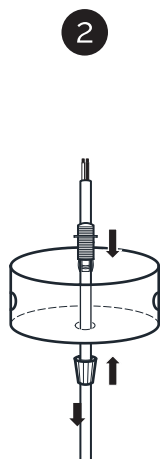

Feed cable through Cord Grip as illustrated to desired length.



Tighten Cord Grip to lock the cable at desired length.

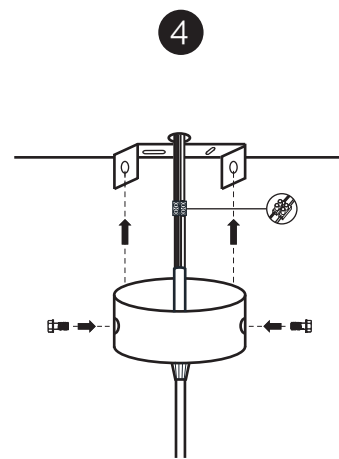

Connect the electrical mains to the pendant light cable using the Connector.

Align Canopy Cup to U-Bracket and fix with Canopy Screws.

Components



Canopy Cup



U-Bracket



Canopy Screw



Wall Plug



Ceiling Screw



Cord Grip (Outer)



Cord Grip (Inner)



Connector

Safety Precautions

1. All products are to be installed by a certified electrician.
2. Please refer to the instructions and Canopy Installation stages for the installation of the fixture.
3. Please do not modify or adjust any fixture in a way that is not clearly stated or intended.
4. All lighting products are intended solely for indoor use.
5. When switching out light globes or cleaning the product please ensure the power is OFF and the globe is not hot.
6. Stephanie Ng Design is not responsible for any damages caused by not following the provided instructions.

For further information such as care and maintenance, product overviews and disclaimers, please visit our website. Please don't hesitate to contact us directly if you have any questions and enquiries at hello@stephaniengdesign.com

Our lighting is designed for 220 - 240V